

CANOPUS

RECESSED TRIM DOWNLIGHT SPECIFICATIONS



Job Information	
Project Name	
Type	
Location	
Quantity	
Date	

DESCRIPTION

The Canopus Series is a high-efficiency recessed downlight with an IP65 rating, making it an excellent choice for wet locations. Available in various wattages and power levels, it comes in sleek black and white finishes.

Ideal for public areas, swimming pools, showers, and more, the Canopus combines durability with performance—perfect for demanding environments where moisture protection is essential.

OVERVIEW

- IP65 Wet location
- Low glare
- 90+ color rendering index (CRI)

PERFORMANCE

MODEL NAME	CANOPUS
POWER CONSUMPTION(±10%)	12W-60W
INPUT VOLTAGE	120VAC/100-277VAC
EFFICACY(4000K RA80)	90 LM/W
DIMMING	TRIAC/0-10V/DALI
CCT	2700/3000/3500/4000K
CRI	90+
BEAM ANGLE	15°/24°/36°/60°
UGR LEVEL	<16
MOUNTING OPTIONS	RECESSED
FINISH	POWDER COATING
TRIM COLOR	BLACK/WHITE
REFLECTOR COLOR	BLACK/WHITE/SILVER
IP RATING	IP65
OPERATING TEMPERATURE	-30°C TO + 50°C(-22°F TO 122°F)
LIFE TIME OF LED @TA=25°C	50000 HRS LM80 ANSI/IES
WARRANTY	3 YEARS
APPLICATIONS	WET LOCATIONS

PRODUCT ORDERING GUIDE

EXAMPLE: CANOPUS-20W-120-3000-36-V-SB-B

SERIES	WATTAGE	VOLTAGE	CCT	BEAM ANGLE	DIMMING	REFLECTOR FINISH	TRIM FINISH
CANOPUS	12W	120: 120 VAC	2700	15	T: TRIAC	WH: WHITE	W: WHITE
	20W	UNV: 110-277 VAC	3000	24	V: 0-10V	SL: SILVER	B: BLACK
	30W		3500	36	D: DALI	SB: SHINY BLACK	
	40W		4000	60			
	50W						
	60W						



FEATURES

► Optics

The design ensures high light transmittance, offering effective light control and anti-glare performance. Beam angles available in 15°, 24°, 36°, and 60°.

► Electrical

Voltage 100-277VAC

► Environment & Certifications

cETL listed for wet locations

► Warranty

3 years limited warranty

► Mounting

Recessed only.

► Trim Finish

The powder-coated finish ensures a uniform appearance, offering long-term durability and superior aesthetics.

► Housing Material

Die-cast aluminum housing ensures durability and efficiency, with heat resistance polycarbonate lens.

► LED System

CRI With a 90+ color rendering index (CRI), this product delivers outstanding illumination, featuring tight chromaticity specifications and a precise color binning process to ensure consistency in CRI and CCT.

CCT Available in 2700K, 3000K, 3500K, 4000K with excellent color consistency.

Thermal Management The aluminum housing serves as an efficient heat sink to maximize lifespan, maintaining heat sink temperatures between 60-70°C

CANOPUS

RECESSED TRIM DOWNLIGHT SPECIFICATIONS

DIMENSIONS

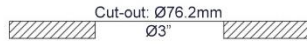

57.15mm
Ø2.25"

12W

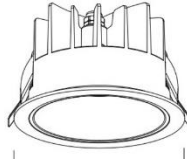
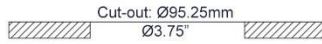

63.5mm
Ø2.5"

20W

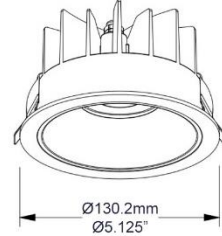
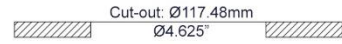

76.2mm
Ø3"

30W

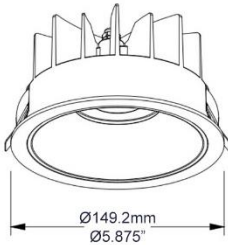
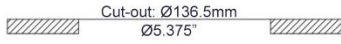

79.4mm
Ø3.125"

40W

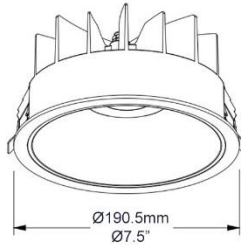
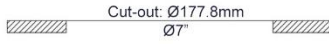

95.25mm
Ø3.75"

50W

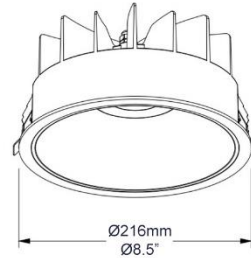
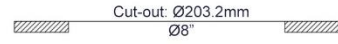

104.8mm
Ø4.125"

60W

